

METACLAMP® for Sanitary Applications & Explosion proof Luminaire USL05

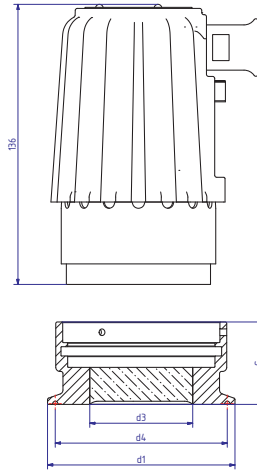

Applications

- Compact unit combining the popular LumiGlass USL-05 Ex explosion proof light with the proven Metaclamp sanitary mounting system. This unit safely illuminates pressurised tanks, pipelines, mixers and any other closed vessels and provides of intense glare free illumination through a METAGLAS® safety Glass lens.

Advantages

- Compact design
- Fast & simple installation with no risk of breakage
- Suitable for food processing (A3-Standard)
- Sight glass resistant to catastrophic failure
- Explosion proof for all explosion classes
- Dust and water jet resistant (IP65) even during external washdown

Operating conditions for sight glass

- Pressure: -1 to 16 bar
- Temperature: see table
- Temperature: (With light) Up to 60°C

Ring

materials

Temperature (TS)

1.4462	-30°C bis +280°C
2.4602	-60°C bis +300°C
2.4610	-60°C bis +300°C

Nominal size

Nominal size			d1	d3	d4	S	Max. operating pressure [bar]
DIN	ISO	ASME BPE					
25/32/40	15/20/25	1", 1½"	50,5	28	43,5	38	16
50	32/40	2"	64	34	56,5	38	16
-	50	2½"	77,5	38	70,5	38	16
65	65	3"	91	50	83,5	38	10
80	80	3½"	106	50	97,0	36	10
100	-	4"	119	55	110,0	37	10

Technical data Manufactured and tested to:

- Directive for pressure equipment 2014/68/EU, Module H (DIN/EN/ISO 9001)
- AD2000 Standards W0/TRD 100
- Sight glass fused to metal conforming to DIN 7079
- Materials to VdTÜV specifications and the DIN/EN designated standards
- Glass: Borosilicate to DIN 7080 / DIN 7079

Material certificates

- Certificate of Conformity to EN 10204-3.1 or 3.2 for extra costs

Sanitary Metaclamp Materials

- Duplex Stainless Steel (1.4462)
- Hastelloy C-22 (2.4602)
- Hastelloy C-4 (2.4610)
- Light / USL05-ES
- Operating voltage:
 - 24 V AC/DC – 7.5 W
 - 110-230 V AC – 7.5 W
- Colour temperature: 6500 K
- Luminous flux: 360-430 lm (depending on beam angle)
- Beam angle: 12°; 25°; 38°
- Certification: EU Type-Examination Certificate BVS 08 ATEX E 133
 - II 2G Ex db IIC T6 Gb
 - II 2D Ex tb IIIC T80°C Db