

**METACLAMP® Sight Glasses for Use with Clamp Connections
and Sight glass Luminaires ESL25**

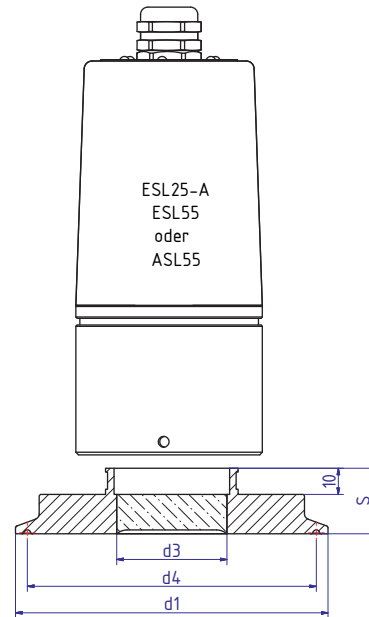

Applications

- Clamp style nozzles
- For ESL25-Sterile, ESL55, ASL55 light fitting

Advantages

- Compact construction
- Aseptic design
- Powerful illumination
- Security against total failure
- Long operating time
- Use in Ex hazardous process areas

Operating conditions

Pressure: -1 to 16 bar

Temperature: see table

Operating conditions for sight glass

Ring

materials	Temperature (TS)
1.4462	-30°C bis +280°C
2.4602	-60°C bis +300°C
2.4610	-60°C bis +300°C

Technical data Manufactured and tested to:

- Directive for pressure equipment 2014/68/EU, Module H (DIN/EN/ISO 9001)
- AD2000 Standards W0/TRD 100
- Sight glass fused to metal conforming to DIN 7079
- Materials to VdTÜV specifications and the DIN/EN designated standards
- Glass: Borosilicate to DIN 7080 / DIN 7079

Material certificates

- Certificate of Conformity EN 10204 – 3.1 or 3.2 for extra costs

For further technical information see data sheet ESL25-Sterile or ESL55

Nominal size			d1	d3	d4	S	Max. operating pressure [bar]
DIN	ISO	ASME BPE					
25/32/40	15/20/25	1", 1½"	50,5	28	43,5	24	16
50	32/40	2"	64	35	56,5	25	16
–	50	2½"	77,5	35	70,5	26	16
65	65	3"	91	40	83,5	22	10
80	80	3½"	106	42	97,0	22	10
100	–	4"	119	42	110,0	25	10